

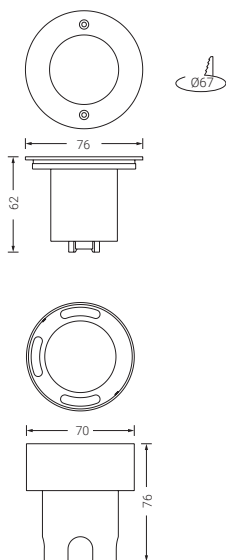

## Recessed step light

24V CBS version available

# Sirio



### Technical features:

- Recessed mounted (recession frame included).
- Reference regulations EN 60598-1
- Power 230V, 50/60 Hz.
- Exterior ring made of ZAMAK with aluminium finishing.
- Housing and diffuser: Polycarbonate
- IP-65. IK-07
- Class II.
- Can be mounted on a flammable surface.
- Charging time 24 hours.
- Possibility of remote control.
- Different light colours.

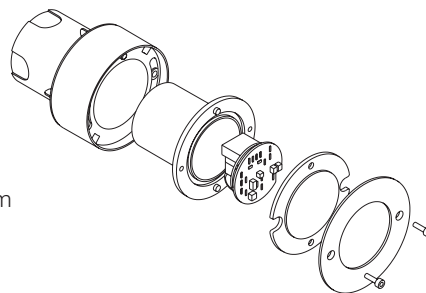

IP 65

	LAMP	COLOUR LED	AUTONOMY	BATTERY	COS (φ)	CONSUMPTION	PACKAGING
<b>BS</b>	LED	White	2 h	3,6 V · 80 mAh	0,07	0,28 W	20
<b>BSA</b>	LED	Blue	2 h	3,6 V · 80 mAh	0,07	0,28 W	20
<b>BSR</b>	LED	Red	2 h	3,6 V · 80 mAh	0,07	0,28 W	20
<b>BSV</b>	LED	Green	2 h	3,6 V · 80 mAh	0,07	0,28 W	20

Available **24v DC**, ref: + Y

24v DC version is compatible with the C24 central battery system (information on page 158) and with the power supply module for step lights MA24-6 (information on page 140).

Step lighting

